

Product Data Sheet

6. Non return valves

6.01 Ball check valve

Flanged ball check valve (BKF) PN10/16

Material EN 1563 EN-GJS-400-15

Design Std. EN 12334

Coating Epoxy GSK RAL-GZ 662

Approval

Kolk ball check valves are made of ductile iron GJS-400/500 (DIN1693 GGG-40/50). Face to face acc. to DIN 3202-F6, flange drilling acc. to EN 1092-2 (ISO 7005-2). Epoxy coated (Resicoat®) acc. to EN 14901 (DIN 30677-2) and GSK certified (RAL-GZ 662). Sinking ball type and upto DN 300 NBR covered iron ball over DN 300 massive PU ball. Floating ball can be delivered upon request.

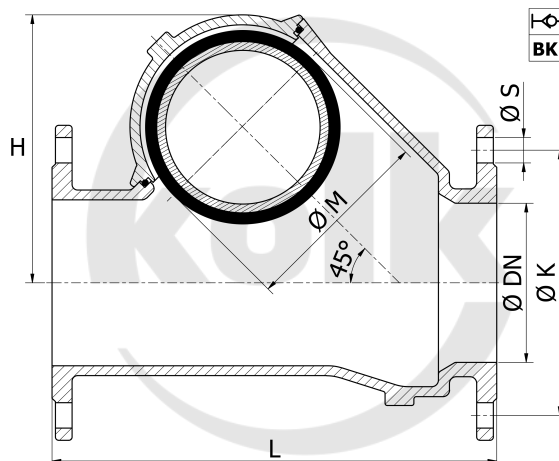

Flanged ball check valve (BKF) PN10/16

Article	Article Nr.	PN	Ø DN [mm]	L [mm]	H [mm]	Ø M [mm]	Holes # [DN]	Ø K [mm]	Ø S [mm]	G [kg]					
BKF 50	6.01BKF2.000010	PN10	50	200	100	60	4	125	19	7					
BKF 65	6.01BKF2.000020	PN10	65	230	145	95	4	145	19	11					
BKF 80	6.01BKF2.000030	PN10	80	260	145	95	8	160	19	12					
BKF 100	6.01BKF2.010010	PN10	100	300	175	120	8	180	19	18					
BKF 125	6.01BKF2.010020	PN10	125	350	250	175	8	210	19	30					
BKF 150	6.01BKF2.010030	PN10	150	400	250	175	8	240	23	35					
BKF 200	6.01BKF2.020010	PN10	200	500	330	240	8	295	23	69					
BKF 250	6.01BKF2.020020	PN10	250	600	400	300	12	350	23	116					
BKF 300	6.01BKF2.030010	PN10	300	700	470	360	12	400	23	184					
BKF 350	6.01BKF2.030020	PN10	350	800	570	420	16	460	23	280					
BKF 400	6.01BKF2.040010	PN10	400	900	655	480	16	515	28	415					
BKF 450	6.01BKF2.040020	PN10	450	1000	655	480	20	565	28	650					
BKF 500	6.01BKF2.050010	PN10	500	1100	840	600	20	620	28	745					
BKF 600	6.01BKF2.060010	PN10	600	1200	950	720	20	725	31	910					
BKF 200	6.01BKF3.020010	PN16	200	500	330	240	12	295	23	69					
BKF 250	6.01BKF3.020020	PN16	250	600	400	300	12	355	28	116					
BKF 300	6.01BKF3.030010	PN16	300	700	470	360	12	410	28	184					
BKF 350	6.01BKF3.030020	PN16	350	800	570	420	16	470	28	290					
BKF 400	6.01BKF3.040010	PN16	400	900	655	480	16	525	31	430					